

## PTWA-060T SERIES



## 6W Power Supply for I.T. Equipment

- Input Voltage 100 to 240 VAC, 50 to 60Hz
- Constant Voltage or Constant Current
- Over Voltage, Short Circuit Protection (Auto Recovery)
- Light Weight and Compact Size
- Class II Insulation
- EUP, Energy Star 2.0 and RoHS compliance

1 Year Warranty

Approvals: 

### Single Output

Product Number	Output Voltage	Max. Output Current	Output Regulation	Maximum Output Power
PTWA-060T-xxxxxyy	3 ~ 15 VDC		5%	6W

### Electrical Characteristics

Parameter	Test Conditions	Min.	Typ.	Max.	Unit
Input Voltage	Operating Voltage	100		240	VAC
Input Frequency		50		60	Hz
Output Power Range		0		6	W
Input Current (rms)	I/P: 90 VAC		0.15		A
Input Current (rms)	I/P: 264 VAC		0.08		A
Hold-up time	Full load at 115 VAC & 230VAC		10		ms
Voltage Regulation	At constant voltage mode		±5		%
Current Limit	At constant current mode		±5		%
Overshoot / Undershoot		15V ±5%			
Efficiency	Io=Full Load, 115 VAC (DC Conversion)	73.8			%
Temperature Coefficient	All output	-0.05		0.05	%/°C
Protection	Over voltage protection (OVP), AC recycle; Short circuit protection; Output short circuit protection				
Automatic Recovery	Automatic recovery when removal of protect condition. Any protect condition shall cause no damage and no component fail. (<0.03 ohm)				

### Approvals and Compliance

Parameter	Test Conditions
Hi-Pot Test	Primary to secondary: 4242VDC for 1 min
Hi-Pot Test	Primary to case: 4242VDC for 1 min
Insulation Resistance	Input to output: >10M ohm @ 500VDC
EMI	FCC Class B, CISPR22 Class B, EN55022 Class B

### Conditions

Parameter	Test Conditions	Min.	Typ.	Max.	Unit
Operating Temperature	Ambient	0		40	°C
Storage Temperature	Ambient	-10		70	°C
Operating Relative Humidity		8		90	%
Storage Relative Humidity		5		95	%
Mean Time Between Failures	Full load, 240VAC, 25°C	0.05M			Hours

## Mechanical and PIN out

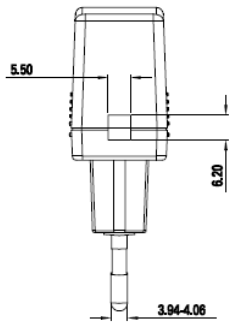
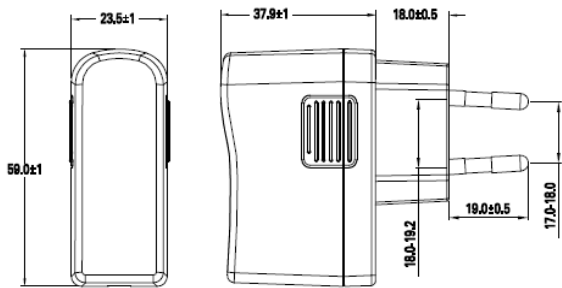

### Note:

1. Dimensions are shown in mm.
2. Weight: 120g approx.
3. Optional output connector